

EP KNIFE GATE VALVE

The EP model knife gate valve is a polyurethane-lined lug type valve designed for general industrial service applications with abrasive fluids. The design of the body and seat also assures non-clogging shut off on suspended solids in industries such as Mining, Pulp & Paper, Power Plants, Chemical Plants, Food & Beverage, etc

Product description:

- Bi-directional lug type knife gate valve
- Size range of DN80-600 (larger sizes upon request).
See Dimension Charts for pressure rating
- Rising stem as standard. Non rising stem also available
- Standard flange connection: EN 1092, ASME B16.5 (class 150) and AS 2129 Table D & E
Others available upon request
- Manual (handwheel, chainwheel, lever and bevel gear), pneumatic (single and double-acting), electric and hydraulic actuation options available
- Directives: For specific EU Directives and other Certificates requirements, please see the Directives & Certificates Compliance - Knife Gate Valves – Catalogues and Datasheets

Features:

- Lug type monoblock ductile iron body with polyurethane lining
- Full bore design
- Stainless steel gate polished both sides to avoid jamming and seat damage
- Long life PTFE impregnated synthetic fibre plus EPDM o-ring packing with easy access and adjustable gland follower. Wide range of packing materials available
- RAL-5015 blue epoxy-coating on all cast iron/carbon steel components
- Automated valves provided with gate guards in accordance with EU Safety Standards
- Actuation accessories: limit & proximity switches, mechanical stops, positioners, solenoid valves, manual overrides, locking devices, fail safe systems, stem extensions and floor stands

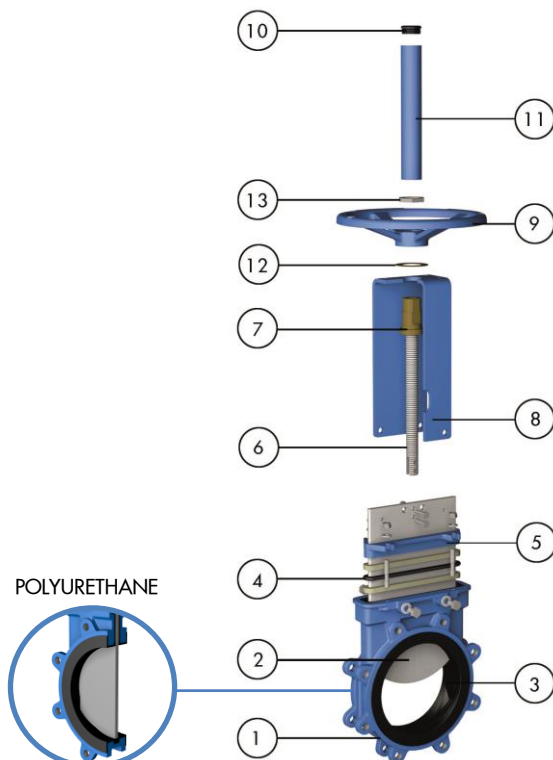

STANDARD PARTS LIST

Part	Material
1 Body	Ductile iron
2 Gate	AISI 304 / AISI 316
3 Seat	Polyurethane
4 Packing	PTFE impreg. synth. fibre and EPDM o-ring
5 Gland follower	A216 WCB
6 Stem	Stainless Steel
7 Stem nut	Brass
8 Yoke	Epoxy-coated carbon steel
9 Handwheel	EN-GJS400
10 Cap	Plastic
11 Stem protector	Epoxy-coated carbon steel
12 Friction washer	Brass
13 Nut	Zinc-plated carbon steel

DIMENSIONS (mm) Handwheel Rising Stem

DN	Pressure	A	B	C	D	E	F	ØG	H	Weight (kg.)
80	10 bar	51	156	100	124	162	47	225	475	10
100	10 bar	51	174	100	140	187	47	225	520	12,5
150	10 bar	57	208	100	175	237	47	225	652	20
200	10 bar	70	272	122	205	309	67	310	822	32
250	10 bar	70	333	122	250	364	67	310	1022	47
300	10 bar	76	384	122	300	414	67	410	1122	65
350	10 bar	76	431	193	338	486	66	410	1323	95
400	10 bar	89	486	193	392	536	66	410	1427	122
450	10 bar	89	540	197	432	588	66	550	1594	160
500	10 bar	114	602	197	485	648	66	550	1707	202
600	10 bar	114	708	197	590	748	66	550	2022	290

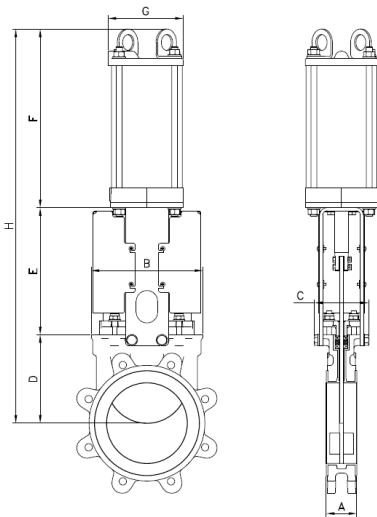
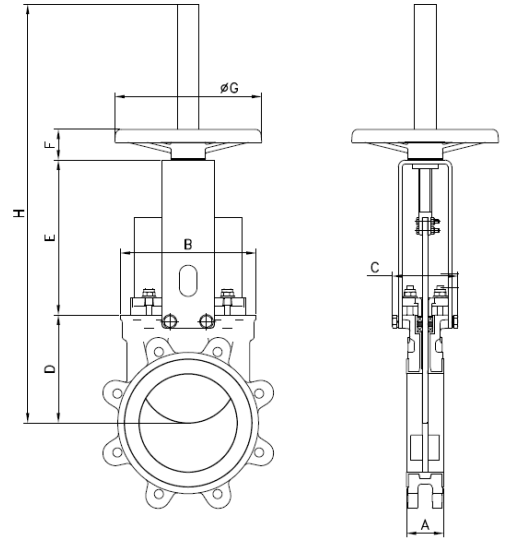

DIMENSIONS (mm) Pneumatic Actuator (D/A)

DN	Pressure	A	B	C	D	E	F	G	H	Weight (kg.)	Standard Cyl.	Connect.
80	10 bar	51	156	100	124	162	211	115	497	12	C100/95	1/4"G
100	10 bar	51	174	100	140	187	231	115	558	15	C100/115	1/4"G
150	10 bar	57	208	100	175	237	296	140	708	27	C125/168	1/4"G
200	10 bar	70	272	122	205	309	358	175	872	46	C160/220	1/4"G
250	10 bar	70	333	122	250	364	428	220	1042	70	C200/270	3/8"G
300	10 bar	76	384	122	300	414	478	220	1192	89	C200/320	3/8"G
350	10 bar	76	431	193	338	500	549	277	1397	135	C250/375	3/8"G
400	10 bar	89	486	193	392	550	599	277	1541	162	C250/425	3/8"G
450	10 bar	89	540	197	432	598	680	382	1710	212	C300/475	1/2"G
500	10 bar	114	602	197	485	658	730	382	1873	290	C300/525	1/2"G
600	10 bar	114	708	197	590	758	830	382	2178	375	C300/625	1/2"G